

### INCREMENTAL

- 50 mm case dimensions
- 100 - 150 - 200 - 360 - 400 - 500 - 600 - 720 - 1000 - 1024  
1800 - 2000 - 2048 - 2500 - 3600 - 4000 - 4096 - 5000 ppr.
- Push-Pull, TTL, Linedriver or HLD output
- Rod diameter 6 - 8 - 10 mm
- 3500 rpm max.



### Technical Specifications

|                                       |   |
|---------------------------------------|---|
| Resolution                            | 100 - 5000 ppr.   |
| Output channels                       | A, B, Z or A, $\bar{A}$ , B, $\bar{B}$ , Z, $\bar{Z}$   |
| Output type                           | Push-Pull, TTL, Linedriver, HLD   |
| Power supply                          | 5 VDC, 8-24 VDC or 5-24 VDC   |
| Power consumption (without load)      | < 40 mA (24 VDC)  |
| Cable                                 | 2,5 meter (standard) 5 wire + shield (Push-Pull)<br>2,5 meter (standard) 8 wire + shield (Linedriver) |
| Max. permissible shaft loading radial | 100 N   |
| axial                                 | 60 N  |
| Displacement speed                    | 3500 rpm (5000 ppr. up to 700 rpm)  |
| Rod diameter                          | Ø6 - 8 - 10 mm  |
| Rod material                          | Stainless steel   |
| Case dimensions                       | Ø50 mm  |
| Case material                         | Aluminium and painted steel   |
| Protection level                      | IP 54   |
| Operating temperature                 | -20°C ... +80°C   |
| Storage temperature                   | -30°C ... +90°C   |

### Mechanical Specifications

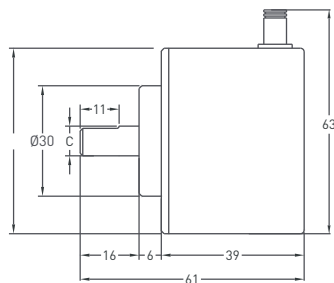

Rod type / Radial

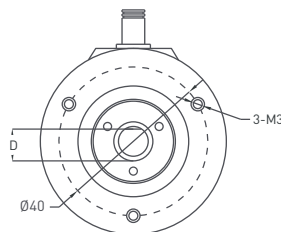

#### Push - Pull Cable Output

- +V : Brown
- 0V : White
- GND : Shield
- Ch A : Yellow
- Ch B : Green
- Ch Z : Gray

#### TTL - HLD - Linedriver Cable Output

- +V : Brown
- 0V : White
- GND : Shield
- Ch A : Yellow
- Ch B : Green
- Ch Z : Gray
- Ch A inv.: Blue
- Ch B inv.: Red
- Ch Z inv.: Pink

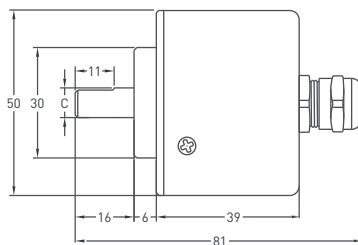

Rod type / Axial

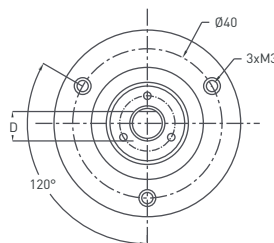

| PRI 50 | R<br>(rod) |        |
|--------|------------|--------|
|        | C          | D      |
|        | Ø6mm       | 5,50mm |
| Ø8mm   | 7,30mm     |        |
| Ø10mm  | 9,00mm     |        |

### Ordering Procedure

| Model | Case diameter | Case type           | Rod diameter                       | Output type   | Resolution      | Output signal  | Supply voltage                                   | Connector / Cable   | Cable output            |
|-------|---------------|---------------------|------------------------------------|---|-----------------|--|--|---|-------------------------|
| PRI   | 50            | A                   | R8                                 | HLD   | 1024            | Z  | V3   | 2M5   | R                       |
| PRI   | 50: 50 mm     | A : Clamping flange | R6 : 6mm<br>R8 : 8mm<br>R10 : 10mm | LTP : Push-Pull<br>LD : Linedriver<br>HLD : High Linedriver<br>TT : TTL | 100 - 5000 ppr. | Z : A, B, Z<br>B : A, B<br>Z $\bar{Z}$ : A $\bar{A}$ , B $\bar{B}$ , Z $\bar{Z}$ | V1 : 5 VDC<br>V2 : 8 - 24 VDC<br>V3 : 5 - 24 VDC | 2M5 : 2,5 meter cable<br>5M : 5 meter cable<br>8M : 8 meter cable<br>10M : 10 meter cable<br>C12 : 12 pin connector | R : Radial<br>A : Axial |